



TASSELLO CTL



SCREW ANCHOR WITH GALVANIZED STEEL SCREW TO SECURE INSULATION PANELS TO WOOD AND SHEET METAL SUPPORTS (UP TO 0.75 MM) FOR SURFACE AND/OR RECESSED APPLICATION. ANCHORING DEPTH 30-40 MM

DIMENSIONAL AND PERFORMANCE PROPERTIES

LENGTH : FROM 12 TO 40 CM

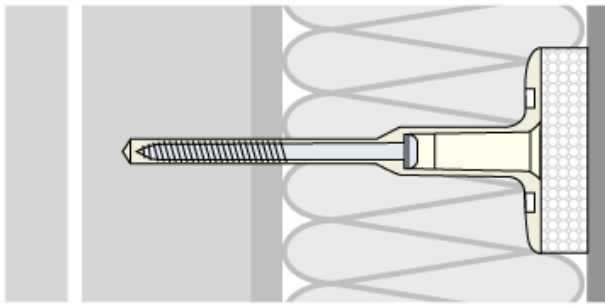

RECESSED INSTALLATION WITH CAPPING ACCESSORY: CAP

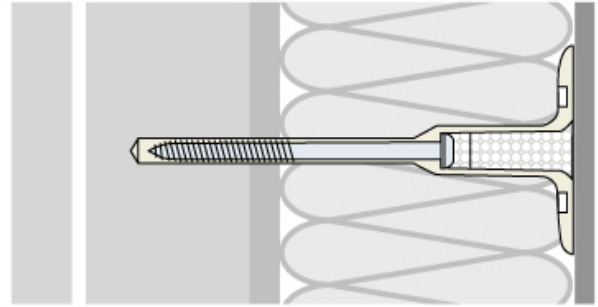

SURFACE INSTALLATION WITH CAPPING ACCESSORY: INSULATING PLUG

TECHNICAL DATA

Screw diameter	6 mm
Disk diameter	60 mm
Depth of hole, recessed installation	≥ 30-40 mm

WEIGHT BEARING CAPACITY CHARACTERISTICS

Fibreboard panel (thickness ≥ 17.0 mm)	0.25 kN
Masonite panel (thickness ≥ 13.0 mm)	0.25 kN
Plasterboard panel (thickness ≥ 12.5 mm)	0.15 kN
OSB panel (thickness ≥ 16.0)	0.25 kN
Solid wood panel (thickness ≥ 27 mm)	0.25 kN

*The recommended loads have been determined applying a safety factor of 3
The loads can differ depending on the works*



TASSELLO CTL



RANGE AVAILABLE

<i>Recessed mounting in insulation (mm)</i>	<i>Flush mounting with surface of insulation (mm)</i>	<i>Name</i>
-	40	CTL o80
-	60	CTL 100
80	80	CTL 120
100	100	CTL 140
120	120	CTL 160
140	140	CTL 180
160	160	CTL 200
180	180	CTL 220

Other lengths available upon request

Packaging units: 100 pieces each

N.B. This Technical Information Sheet is compiled to the best of our technical/scientific knowledge. Nevertheless, it is not binding and does not imply that we are responsible, as the conditions of use are outside our control. It is recommended that the product is always checked as being suitable for the specific application.

IVAS Industria Vernici S.p.A. – Via Bellaria, 40 – 47030 San Mauro Pascoli (FC) – Italy
Tel. +39 0541 815811 Fax + 39 0541 933112 www.gruppoivas.com ivas@gruppoivas.com